

ecofrost

7950.5135

Onderdelen informatie

Erzatzteil information

Spare part information

Information de pièces



Date: 2017. 10. 12

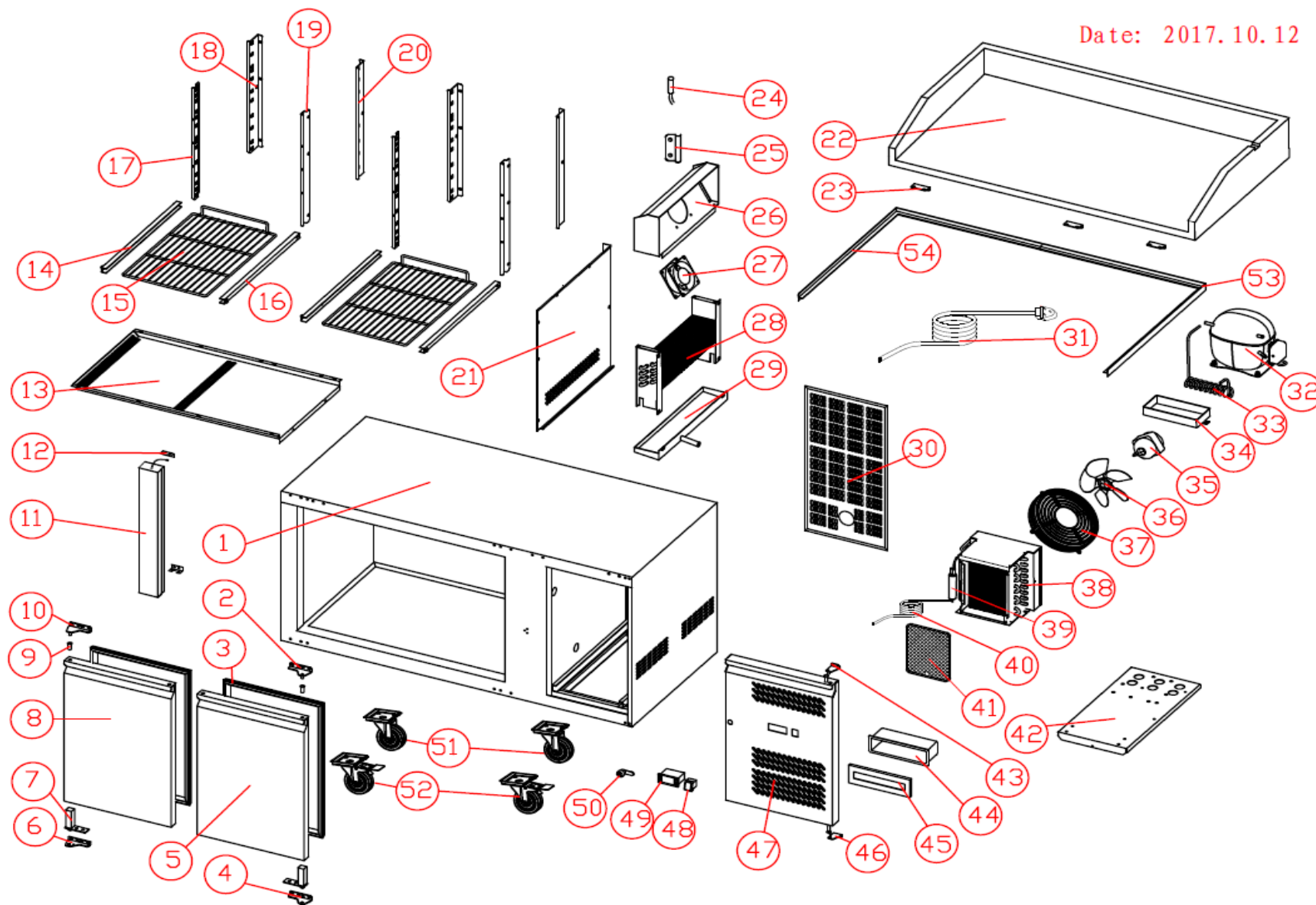

Onderdelenlijst 7950.5135

| POS: | Art.No.: | Omschrijving: | Aantal: |
|------|-----------|-------------------------------|---------|
| 1 | | cabinet | 1 |
| 2 | 9338.3905 | right upper hinge | 1 |
| 3 | 9338.3060 | door gasket | 2 |
| 4 | 9338.3910 | right bottom hinge | 1 |
| 5 | | door(right) | 1 |
| 6 | 9338.3920 | left bottom hinge | 1 |
| 7 | 9338.3080 | spring hinge | 2 |
| 8 | | door(left) | 1 |
| 9 | 9338.3275 | door axis sleeve | 4 |
| 10 | 9338.3915 | left upper hinge | 1 |
| 11 | | middle beam | 1 |
| 12 | | middle beam connect | 2 |
| 13 | | air guide board | 1 |
| 14 | | left shelf guide | 2 |
| 15 | | shelf | 2 |
| 16 | | right shelf guide | 2 |
| 17 | | beam hang strip(left) | 2 |
| 18 | | rear hang strip(left) | 2 |
| 19 | | beam hang strip(right) | 2 |
| 20 | | rear hang strip(right) | 2 |
| 21 | | fan cover | 1 |
| 22 | | stone | 1 |
| 23 | | top fixing plate | 3 |
| 24 | 9338.3515 | probe | 1 |
| 25 | | probe cover | 1 |
| 26 | | eva. Fan cover | 1 |
| 27 | 9338.3540 | eva. Fan | 1 |
| 28 | 9338.3475 | evaporator | 1 |
| 29 | 9338.3220 | evaporator drain pan | 1 |
| 30 | | back cover | 1 |
| 31 | 9338.3530 | power cord | 1 |
| 32 | 9338.3425 | compressor | 1 |
| 33 | 9338.3960 | high pressure pipe | 1 |
| 34 | 9338.3225 | outer drain pan | 1 |
| 35 | 9338.3615 | cond. Fan motor | 1 |
| 36 | | cond. Fan blade | 1 |
| 37 | 9338.3585 | cond.fan cover | 1 |
| 38 | 9338.3450 | condenser | 1 |
| 39 | 9338.3460 | dryer filter | 1 |
| 40 | 9338.3190 | capillary | 1 |
| 41 | 9338.3260 | dryer filter | 1 |
| 42 | | cooling unit board | 1 |
| 43 | 9338.3925 | control panel upper hinge | 1 |
| 44 | 9338.3930 | plastic water-proof box | 1 |
| 45 | 9338.3935 | plastic water-proof box cover | 1 |
| 46 | 9338.3940 | control paner bottom hinge | 1 |
| 47 | | panel | 1 |

Onderdelenlijst 7950.5135

| POS: | Art.No.: | Omschrijving: | Aantal: |
|-------------|-----------------|----------------------|----------------|
| 48 | 9344.0105 | power switch | 1 |
| 49 | 9338.3545 | controller | 1 |
| 50 | 9338.3115 | door lock | 1 |
| 51 | 9338.3085 | wheel | 2 |
| 52 | 9338.3090 | wheel(with lock) | 2 |
| 53 | | metal frame(right) | 1 |
| 54 | | metal frame(left) | 1 |